



\$ 194,838*



4



2



2

Caloola 188

Sqm: 185.56m²

Inclusions

- ▶ Frontage as per image
- ▶ Laminated kitchens with Caesar Stone Tops
- ▶ Premium Porcelain tiled floors throughout house
- ▶ 5000L Water Tank
- ▶ Premium carpets from Builders range
- ▶ Bag & paint rest of house
- ▶ Termite Protection
- ▶ Turf & Fence allowance
- ▶ Driveway, clothesline & letterbox

This house package is suitable for the following Lots:

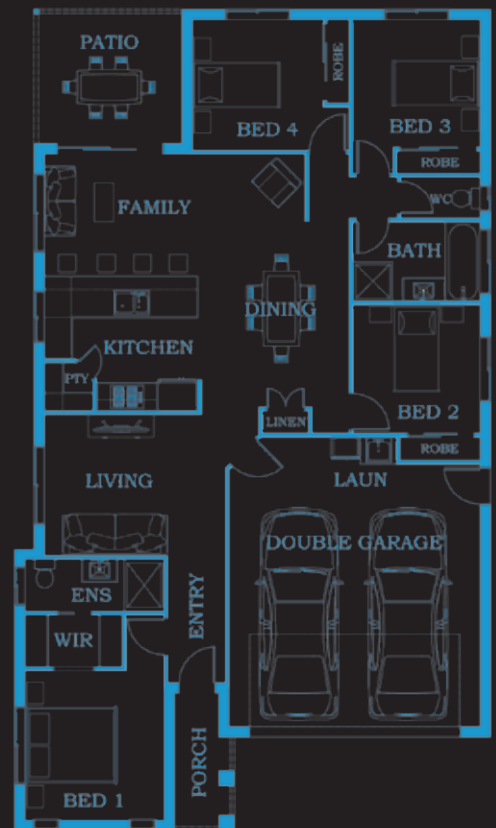
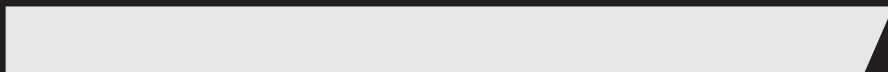

* This price is based on Alpine Homes Caloola Specification. 'M' Class slab design, allowance of 150m² turf and landscaping.

Retaining walls and brick base build up to be Variations and are not included in this price. Confirmation of price to be determined once sewer, stormwater, soiltest, engineering, surveyors & town planning have been provided.

QBSA# 720568

Contact Us
Today!

Level 1 Suite 43,
223 Calam Rd, Sunnybank Hills
e: info@alpinehome.com.au

p: 07 3711 2022

